

# AV1000

Preparation box

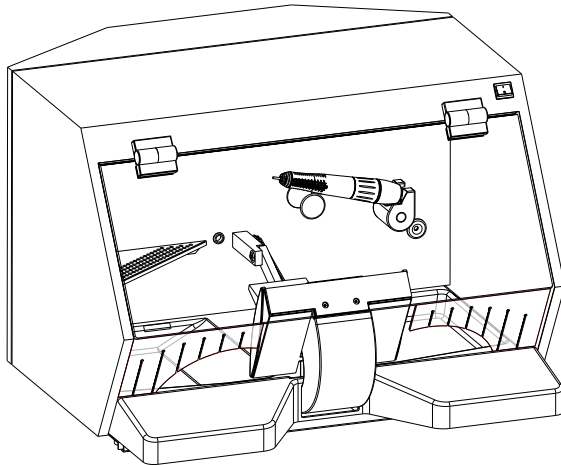

EN 12-2021

 **zubler**<sup>®</sup>

dental & technik

[www.zubler.de](http://www.zubler.de)



# Content

<b>0. Introduction</b>	Page 3
0.1 Conformity declaration	
0.2 Regular usage	
<b>1. Installation</b>	Page 4
1.1 Setting up	
1.1.1 Placement and connections	
1.2 Operation	
<b>2. Maintenance</b>	Page 6
2.1 Cleaning	
2.2 Replacing the fluorescent tube	
<b>3. Data</b>	Page 11
3.1 Technical data	
3.2 Accessories	

# 0. ■ Introduction

Dear customer,

we are pleased that you have made the decision to purchase a zubler product and wish you a comfortable working with our equipment.

The AV1000 preparation box is especially designed to improve the dust collection of dust intensive work, thus protecting the operator from hazardous dusts. The built in lighting provides a perfect illumination of the workpiece and enables together with the adjustable work block an ergonomic operation.

We are asking you to read the instructions carefully before putting the installation into operation. For damages caused by non-observance of the operating instructions, no liability can be accepted.

## 0.1 Conformity declaration

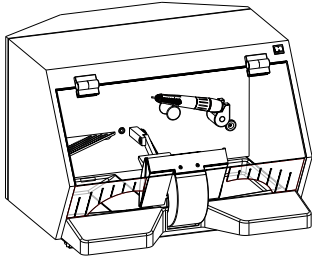

We, Zubler Gerätebau GmbH  
Buchbrunnenweg 26  
89081 Ulm Jungingen

hereby declare, that the preparation box

### **AV1000**

is in compliance with the protective requirements in accordance with the provisions of the following directives:

2014/30/EU EMC Directive  
2014/35/EU Low Voltage Directive  
2006/42/EG Machinery Directive  
2011/65/EU RoHS,

In case of any changes being made to the product without our agreement, this statement is no longer valid.

A handwritten signature in black ink, appearing to read 'Kurt Zubler'. The signature is stylized and cursive.

Ulm, den 15. July 2005  
Kurt Zubler  
Managing Director

## 0.2 Working condition

**The AV1000 preparation box is designed for the usage in dental**

**laboratories and similar professional fields (e.g. goldsmith, hearing**

**aid acoustician, model maker)**

- The AV1000 is for indoor usage and may be operated in the following ambient conditions only:  
Temperature : 5 - 40 C  
Relative humidity : max. 80% @30 C / 50% @40 C
- Before connecting the AV1000 to the mains power, check if the voltage given on the number plate corresponds with the specifications of your local mains power supply.
- For a proper usage a stable mains power supply is required with voltage fluctuations below 10% of the rated value.
- The compressed air must be dry, oil free and may not exceed 10 bar.

# 1. ■ Installation

## 1.1 Setting up

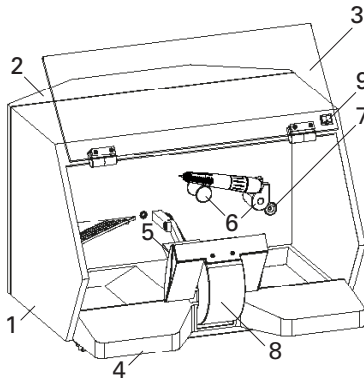

1 Main housing

2 Back cover

3 Glass shield

4 Dust tray

5 Work block

6 Handpiece rest

7 Cable duct

8 Suction funnel

9 Main switch

### 1.1.1 Placement and connections

- Place the AV1000 on a sufficient stable and even workbench or use the optional available stand FG1000.
- Place your handpiece on the handpiece rest (6) and guide the handpiece cable trough both cable ducts (7+15). Therefore remove the cable ducts and insert it again together with the handpiece cable. (Do NOT remove the back cover (2) !)
- Plug the handpiece cable into the handpiece control unit.

- Connect the AV1000 to the compressed air supply by sliding the enclosed pressure hose to the compressed air connector (12) and tighten the clamp screw (maximum 3,0bar).
- Connect the vacuum hose of the suction unit with the vacuum connector (11).
- Connect the hose of the foot switch with the foot switch connector (16).

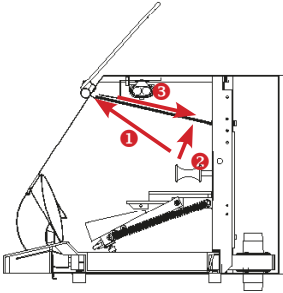

- Plug the enclosed fluorescent tube into the lamp socket and push the tube carefully into the plastic holder.
- Insert the enclosed lighting shield:
  - 1 Slide the lighting shield into the front rail close to the hinges
  - 2 Swivel the shield upwards
  - 3 Slide the shield backwards into the rear rail
- Always remove the lighting shield for transportation.
- Check if the voltage given on the number plate corresponds with the specifications of your local mains power supply.
- Connect the AV1000 to the mains power supply. Therefore plug the enclosed power cord into the low heat device socket (14) and into a local power socket.

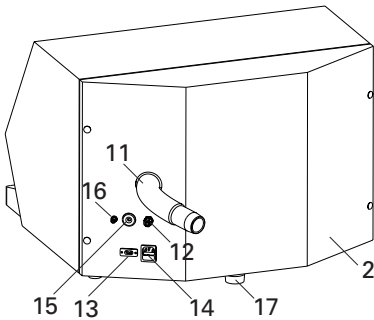

2	Back cover
11	Vacuum connector
12	Compressed air connector
13	Start signal connector
14	Low-heat-device connector with fuse
15	Cable duct
16	Foot switch connector
17	Vacuum connector (optional)

## 1.2 Operation

- The AV1000 is started by switching the main switch (9) to ON (I) position. The main switch is illuminated and the lighting is started
- If using a single station vacuuming unit, it should be switched to continuous operation, otherwise there is no suction if using the cleaning jet.
- If using a zubler central suction the suction starts automatically if activating the cleaning jet. Therefore you need to connect the start signal connector (13) with the automatic opener AP500 (not included)
- The cleaning jet is activated by pressing the foot switch.



# 2. ■ Maintenance

## 2.1 Cleaning

- The dust tray (4) can be easily removed and cleaned on a suitable place.
- 1 Open the glass shield (3)
- 2 Pull out the suction funnel (8)
- 3 Swivel the work block (5) upwards
- 4 Pull out the dust tray (4)
- Put all parts together in reverse order.

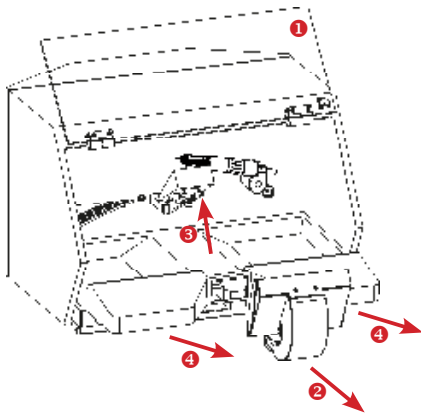

## 2.2 Replacing the fluorescent tube

- Remove the lighting shield like described in 1.1.1 page 7 in reverse order.
- Pull the fluorescent tube carefully downwards out of the plastic holder.
- Pull the tube carefully out of the lamp socket. CAUTION !

## 3. ■ Data

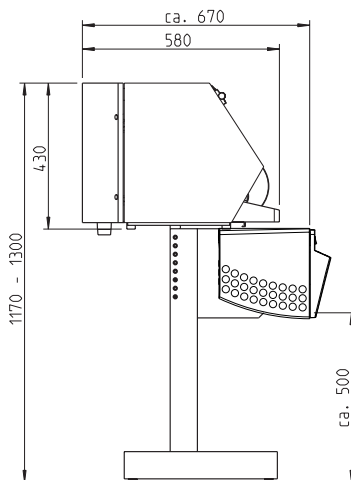
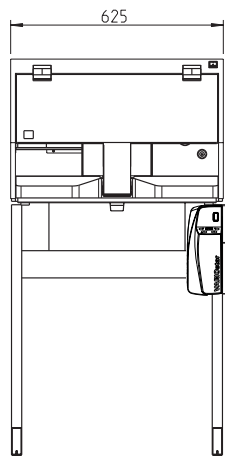

### AV1000

### Best-Nr.

Preparation box

825-310

Preparation box with Dust protection

825-311

### 3.1 Technical data

Width x Height x Depth

24.5 x 17 x 23 mm

Weight

57lbs

Mains voltage

230 V~ 5%/ 50 Hz

Max. power consumption

max. 550 W

Main fuse (low-heat-device socket)

T6,3 A (tr ge)

### 3.2 Accessories:

Fluorescent tube

520-0017

LED tube

520-0024

Glass shield

557-174

Glass shield with Dust protection

557-1741

Lighting shield

557/173

Suction funnel AV1000

752/183

Dust tray

563/085

Stand FG1000

825/324

Knee control plate

570/2333



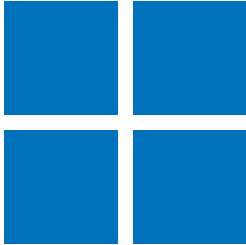

Zubler Gerätebau GmbH  
Buchbrunnenweg 26  
89081 Ulm-Jungingen  
Germany