

Instructions for the suction channel

R1000, R2000 / R1300, R2300

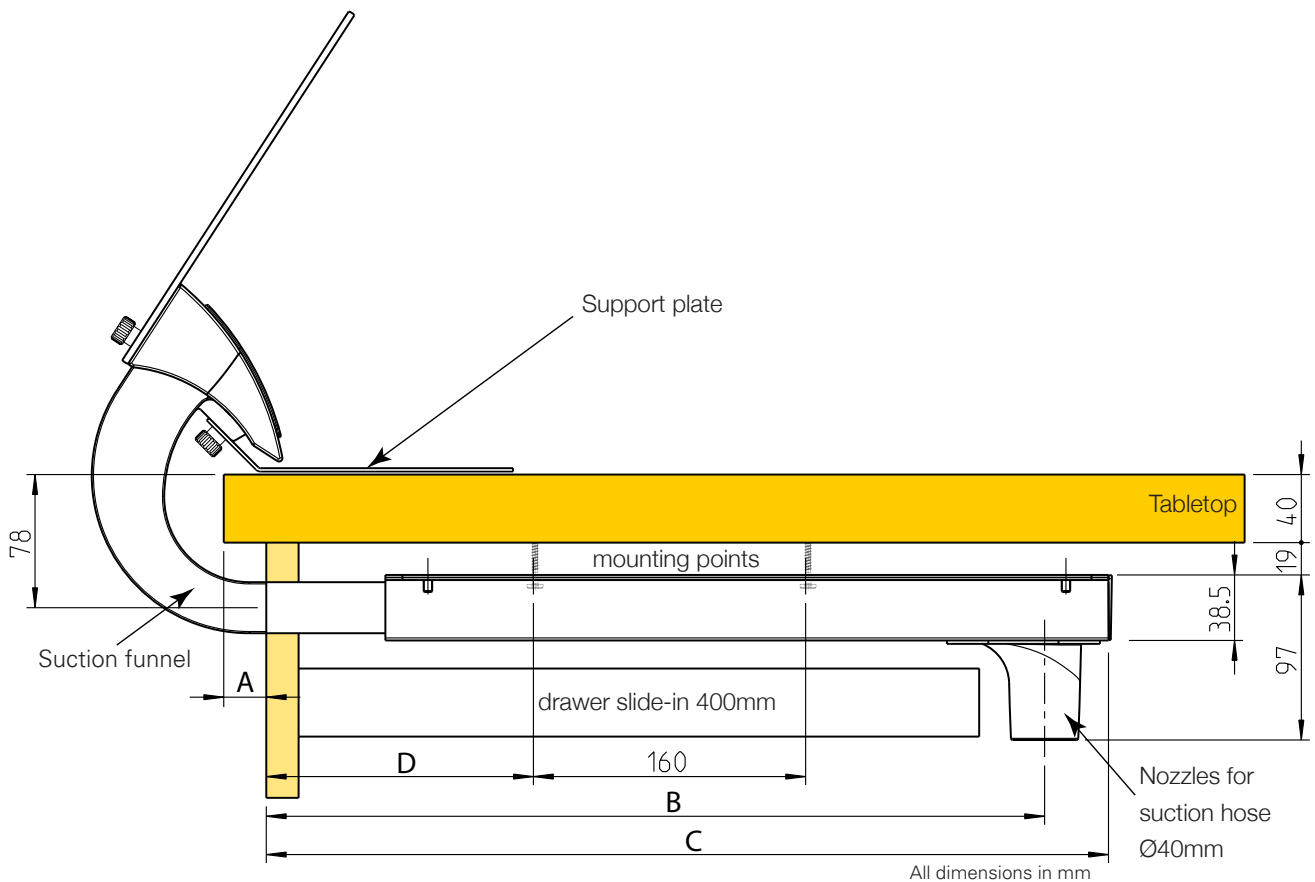

R2200 suction funnel and R2000 rectangular pipe

In addition to optimal dirt capture, the basic requirements for a suction system are the avoidance of annoying flow noises and the promotion of an ergonomic working position.

The fixed rectangular pipe (80 x 30 mm aluminum profile) with suction funnel should be positioned in the middle of the workbench for optimal use. The channel is inserted through the front panel of the furniture (see second page). The suction channel can be screwed upwards with four screws.

Dimensions can be found in the tables below.

 The Nozzles is suitable for connection with a hose D = 40 mm.
Different table overhangs or special lengths are possible on request.

Suction funnel

	A
R1200, R1250, R1260	0- 23 mm
R2200	0- 50 mm

Rectangular pipe

	B	C	D
R1000, R2000, R2300	455 mm	495 mm	157 mm
R1000F, R2000F, R1300, R2300F (F = Freuding)	365 mm	415 mm	87 mm
R1000S X	X- 40 mm	X mm	157 mm
R2000S X, R2300S X (S = special lengths, X = overall length)	X- 40 mm	X mm	X- 338 mm

Technical changes reserved! 48-2023.en

info@zubler.de

Tel.: +49(0)731- 1452 0

Fax: +49(0)731- 1452 13

Zubler Gerätebau GmbH

Buchbrunnenweg 26

D-89081 Ulm Jungingen

www.zubler.de

Movable rectangular channels

R1300, R2300

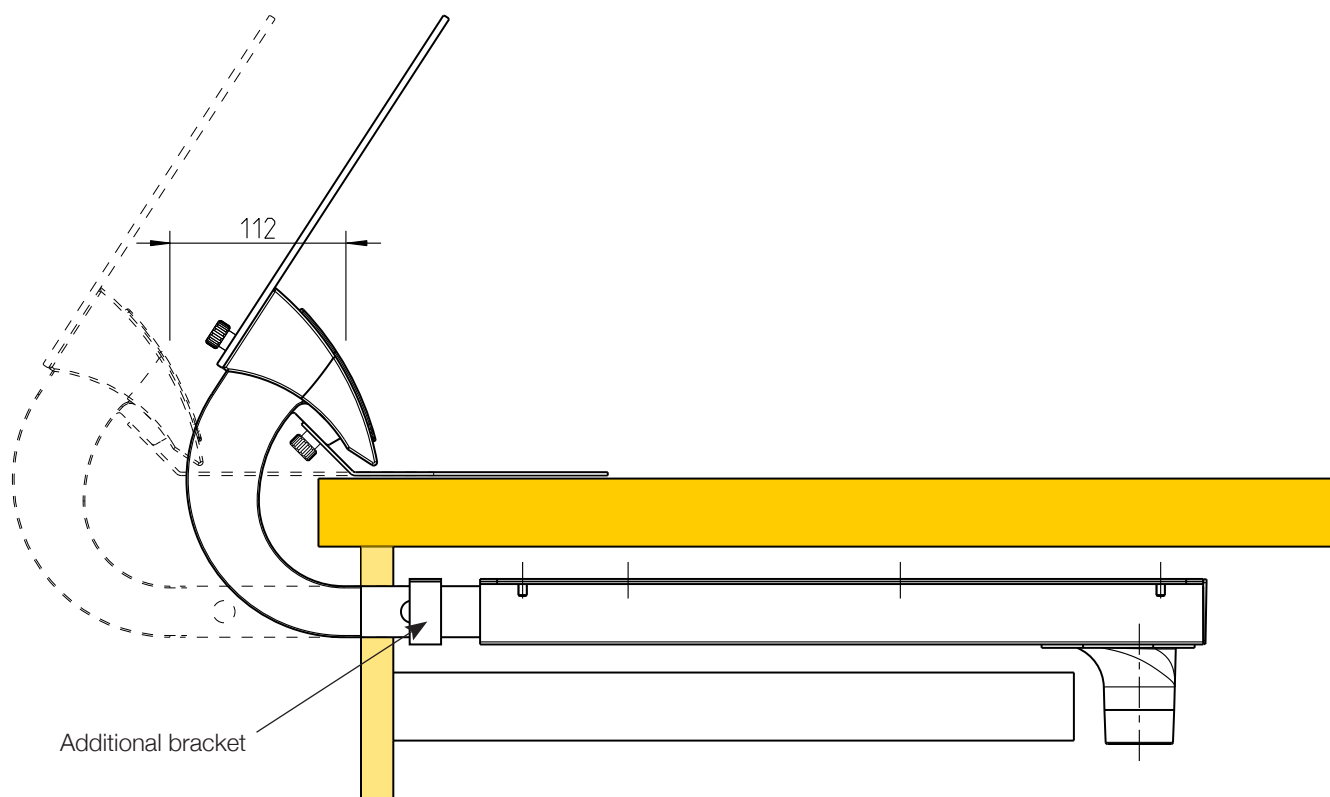

For the movable rectangular channels, we recommend expanding the cutout to 81 x 31 mm. In addition, the channel can be additionally stabilized with the additional bracket.

Front panel cutout

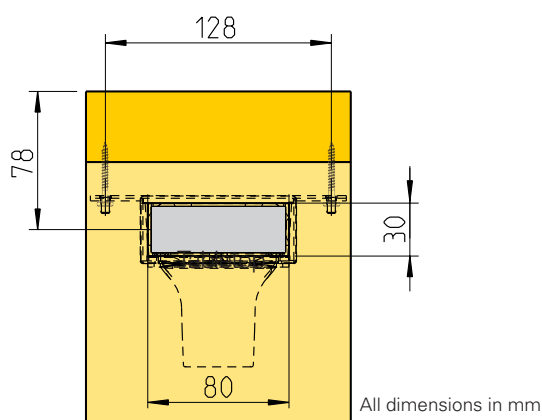

Fixed rectangular pipe			Best.-Nr.	Movable rectangular channel			Best.-Nr.
R1000	495mm		570/0650	R1300	423 mm		825/228
R1000S			570/0657	R2300	495 mm		825/232
R1000F	415mm		570/065	R2300S			825/232S
R2000	495mm		570/066	R2300F	445 mm		825/2320
R2000S			570/0661				
R2000F	445mm		570/0660				

F = Freuding, S = Sonderlänge(X = Länge angeben)

Technical changes reserved! 48-2023.de

info@zubler.de

Tel.: +49(0)731 - 1452 0

Fax: +49(0)731 - 1452 13

Zubler Gerätebau GmbH

Buchbrunnenweg 26
D-89081 Ulm Jungingen
www.zubler.de